

easy

The system:

- it supports 3 load classes (A15, B125, C250) in compliance with Standard EN 1433
- it is made up of a channel - entirely made from HD-PE - which needs no strengthening frame
- it comprises 4 different types of gratings (with rungs, slots, square mesh, anti-heel mesh) made from galvanised steel, stainless steel and ductile iron
- it is supplemented with a whole series of L-shaped longitudinal- slot gratings in class C250 equipped also with drain boxes
- it comes equipped with a classic tie-rod fixing system
- it is ideal for household and civil uses, pedestrian areas, private car parks, footways, canalisation systems in roads and parking areas
- is ideal whenever high-quality aesthetic finishes are to be achieved, since the gratings rest directly on the channel's contact surface, thus covering it completely
- it comes complete with drain boxes with siphon
- the range is made up of 10 channels with 3 widths and 5 heights (100/55, 100/80, 100/100, 100/160, 150/40, 150/100, 150/160, 200/40, 200/100, 200/160, 200/250)





100



CHANNELS

**easy
100**

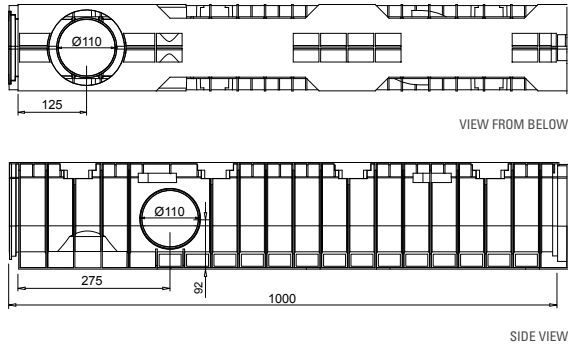

EASY 100/160								
CODE	PRICE	MATERIAL	EXTERNAL DIMENSIONS L x l x h	INTERNAL DIMENSIONS L x l x h	WEIGHT	SECTION DRAINAGE	CAPACITY	PREINSTALLED DRAIN
	€		mm	mm	Kg	cm ²		mm
700000		PE-HD	1000 x 158 x 194	1000 x 100 x 160	2,40	145,28	14,52	side 2 x Ø 110 bottom 1 x Ø 110

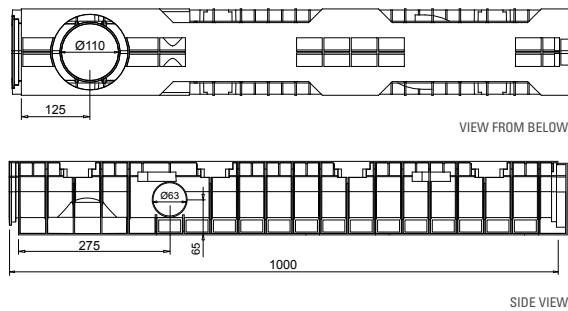

EASY 100/100								
CODE	PRICE	MATERIAL	EXTERNAL DIMENSIONS L x l x h	INTERNAL DIMENSIONS L x l x h	WEIGHT	SECTION DRAINAGE	CAPACITY	PREINSTALLED DRAIN
	€		mm	mm	Kg	cm ²		mm
700001		PE-HD	1000 x 158 x 134	1000 x 100 x 100	1,90	89,56	8,95	side 2 x Ø 63 bottom 1 x Ø 110

N.B. Waterproofing: in order to ensure the channels are waterproof, a bituminous adhesive sealant should be used. Heat-sealing the channel joints makes sure there will be no leakages through said joints for a very long time. For further information please contact MufleSystem's Technical Department.
N.B. Sizes and weights are subject to usual manufacturing tolerance values.



CHANNELS

**easy
100**

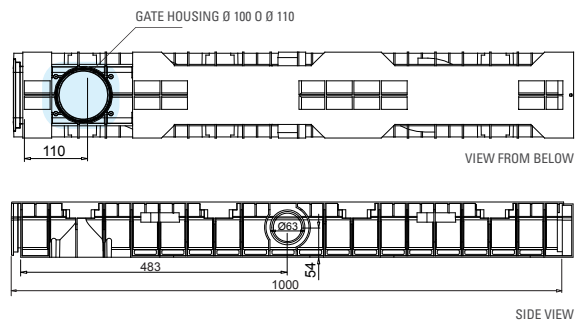

EASY 100/80								
CODE	PRICE	MATERIAL	EXTERNAL DIMENSIONS L x l x h	INTERNAL DIMENSIONS L x l x h	WEIGHT	SECTION DRAINAGE	CAPACITY	PREINSTALLED DRAIN
	€		mm	mm	Kg	cm ²		mm
700006		PE-HD	1000 x 158 x 100	1000 x 100 x 80	1,60	69,28	6,7	side 2 x Ø 63 bottom ¹ 1 x Ø 100; 1 x Ø 110

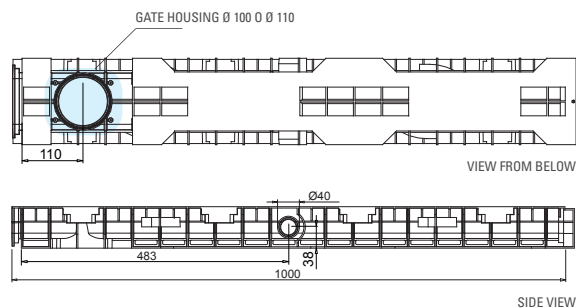

EASY 100/55								
CODE	PRICE	MATERIAL	EXTERNAL DIMENSIONS L x l x h	INTERNAL DIMENSIONS L x l x h	WEIGHT	SECTION DRAINAGE	CAPACITY	PREINSTALLED DRAIN
	€		mm	mm	Kg	cm ²		mm
700007		PE-HD	1000 x 158 x 75	1000 x 100 x 55	1,40	54,44	5,50	side 2 x Ø 63 bottom ¹ 1 x Ø 100; 1 x Ø 110

1- For drainage purposes use the drain gate with outlet kit (available in two versions Ø100 and Ø110).
 N.B. Waterproofing: in order to ensure the channels are waterproof, a bituminous adhesive sealant should be used. Heat-sealing the channel joints makes sure there will be no leakages through said joints for a very long time. For further information please contact MufleSystem's Technical Department.
 N.B. Sizes and weights are subject to usual manufacturing tolerance values.



GRATINGS



**easy
100**

APPLICATIONS OF GALVANISED STEEL

Green areas and parks
Pedestrian areas and/or cycle lanes
Sports facilities
Terraces

APPLICATIONS OF STAINLESS STEEL

Green areas and parks
Pedestrian areas and/or cycle lanes
Sports facilities
Terraces
Kitchens in hospitals, restaurants and similar facilities

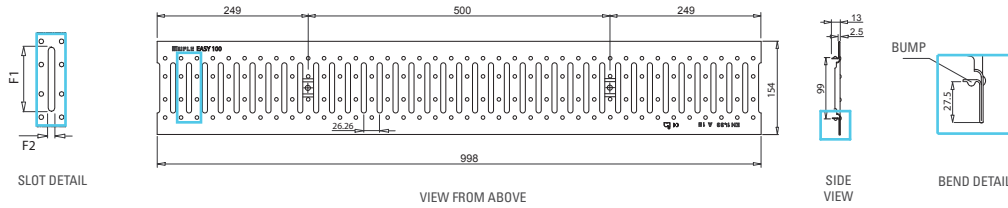

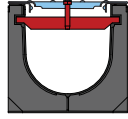
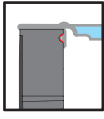
SLOTTED GRATING								13 mm	
CODE	PRICE €	MATERIAL	DIMENSIONS L x l x h mm	WEIGHT Kg	SECTION DRAINAGE cm ²	OPENINGS F1 X F2 mm	FIXING SYSTEM		
							tie-tod	bugna	
500109		galvanised steel DX51D ³	998 x 154 x 2,5	1,80	2,68	83,0 x 8,5			
500111		pickled stainless steel AISI 304 ²							
500170		galvanised steel DX51D ³	498 x 154 x 2,5	0,90	1,34				
500172		pickled stainless steel AISI 304 ²							

2- Classification according to American Standard ASTM.

3- Classification according to Standard EN 10142 (2002) and symbolic designation according to EN 10027-1 (-2) (2006).

N.B. Sizes and weights are subject to usual manufacturing tolerance values.



GRATINGS

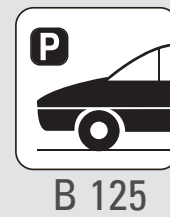

**easy
100**

APPLICATIONS OF GALVANISED STEEL

Pavements
Lay-bys and private car parks

APPLICATIONS OF STAINLESS STEEL

Pavements
Lay-bys and private car parks
Food factories
Chemically aggressive environments

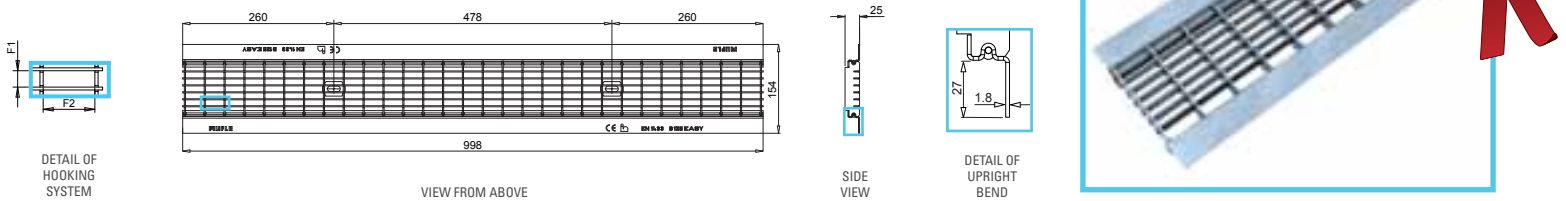

ANTI-HEEL MESH GRATING								25 mm	
CODE	PRICE	MATERIAL	DIMENSIONS L x l x h	WEIGHT	SECTION DRAINAGE	OPENINGS F1 X F2	FIXING SYSTEM		
	€		mm	Kg	cm ²	mm	tie-tod	no fixing	
500105		hot dip galvanised steel DD11 (1.0332) ⁵	998 x 154 x 1,8	3,90	6,66	10,2 x 32,2		up to Class C250 as per Standard EN 1433	
500104		pickled stainless steel AISI 304 ²							
500166		hot dip galvanised steel DD11 (1.0332) ⁵	498 x 154 x 1,8	1,95	3,33				
500165		pickled stainless steel AISI 304 ²							

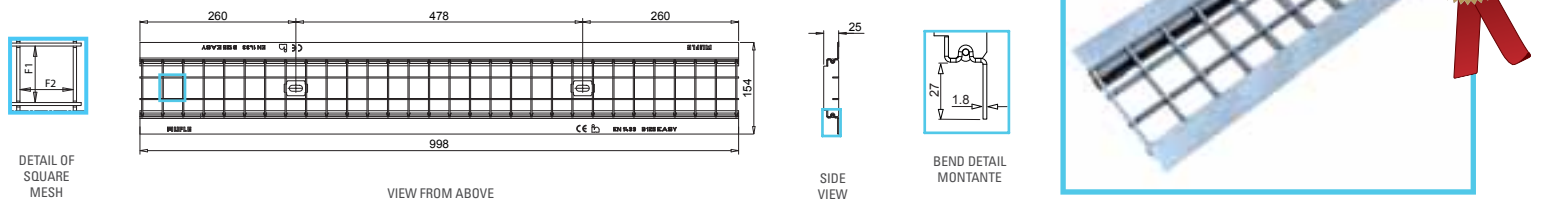

SQUARE MESH GRATING								25 mm	
CODE	PRICE	MATERIAL	DIMENSIONS L x l x h	WEIGHT	SECTION DRAINAGE	OPENINGS F1 X F2	FIXING SYSTEM		
	€		mm	Kg	cm ²	mm	tie-tod	no fixing	
500106		hot dip galvanised steel DD11 (1.0332) ⁵	998 x 154 x 1,8	3,30	9,50	34,2 x 32,2		up to Class C250 as per Standard EN 1433	
500108		pickled stainless steel AISI 304 ²							
500167		hot dip galvanised steel DD11 (1.0332) ⁵	498 x 154 x 1,8	1,65	4,75				
500169		pickled stainless steel AISI 304 ²							

2- Classification according to American Standard ASTM.
5- Classification according to Standard EN 10111 (2008) and symbolic designation according to EN 10027-1 (-2) (2006).
N.B. Sizes and weights are subject to usual manufacturing tolerance values.



GRATINGS

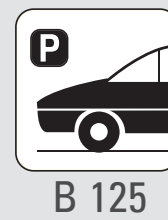

**easy
100**

APPLICATIONS OF DUCTILE IRON

Pavements
Lay-bys and private car parks



SLOT DETAIL

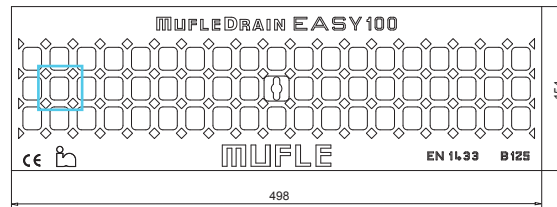

VIEW FROM ABOVE

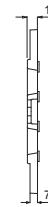

SIDE VIEW

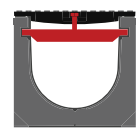

MESH GRATING								 13 mm	
CODE	PRICE	MATERIAL	DIMENSIONS L x l x h	WEIGHT	SECTION DRAINAGE	OPENINGS F1 X F2	FIXING SYSTEM		
	€		mm	Kg	cm ²	mm	tie-tod	no fixing	
500143		GJS 500/7 ⁶ ductile iron water based paint coated	498 x 154 x 7	3,00	2,15	21,5 x 17,5		up to class C250 as per Standard EN 1433	

6- Classification according to Standard EN 1563 (2009).



SLOTTED GRATING T

TYPE C 250
MIDDLE
DRIVEWAY

**easy
100**

APPLICATIONS OF GALVANISED STEEL

Low visual impact drainage in public and private places:
Pedestrian areas
Private car parks or multi-level car parks
Roads subjected to middle loads (urban speed ≤ 40 km/h)
Areas not subjected to dock movements

APPLICATIONS OF STAINLESS STEEL

Low visual impact drainage in public and private places:
Pedestrian areas
Private car parks or multi-level car parks
Roads subjected to middle loads (urban speed ≤ 40 km/h)
Areas not subjected to dock movements

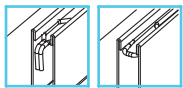

DETAIL OF HOOKING SYSTEM⁸

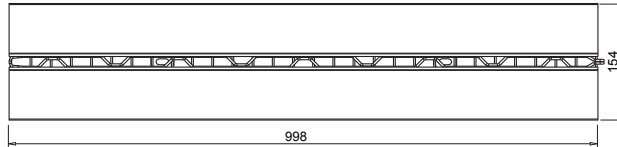

VIEW FROM ABOVE

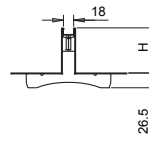

SIDE VIEW

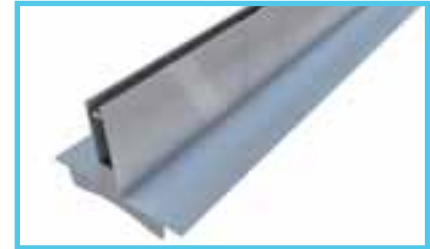

T-SHAPED GRATING

CODE	PRICE €	MATERIAL	DIMENSIONS L x l x h mm	HEIGHT OF SLOTS H mm	WEIGHT Kg	SECTION DRAINAGE cm ²	OPENINGS F1 x F2 mm
500206		hot dip galvanised steel DD11 (1.0332) ⁵	998 x 154 x 106,5	80	4,80	1,80	998 x 18
500218		pickles stainless steel AISI 304 ²					
500207		hot dip galvanised steel DD11 (1.0332) ⁵	998 x 154 x 146,5	120	5,90	1,80	
500243		pickles stainless steel AISI 304 ²					

2- Classification according to American Standard ASTM.

5- Classification according to Standard EN 10111 (2008) and symbolic designation according to EN 10027-1 (-2) (2006).

8- Hooking System between the gratings through hooks and holes.

N.B. Sizes and weights are subject to usual manufacturing tolerance values.



INSPECTION ELEMENT FOR T-SHAPED GRATING

TYPE C 250
MIDDLE
DRIVEWAY

**EASY
100**

CONTAINMENT TANK

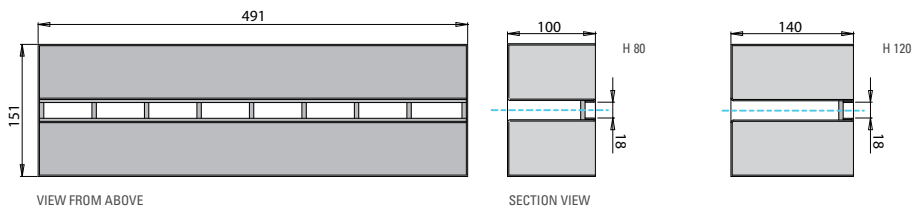
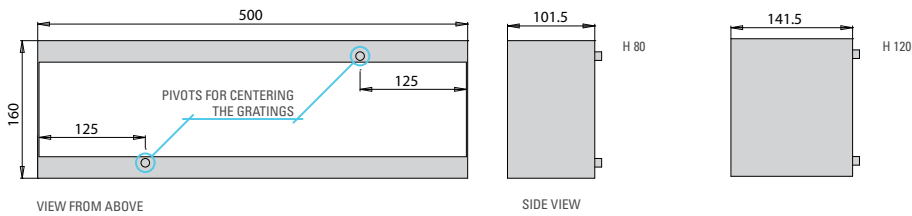

The inspection element for the T-shaped gratings shall be assembled together with the drain box with siphon EASY in HD-PE as showed in the picture. Please see page 44 for the details of the drain box with siphon.

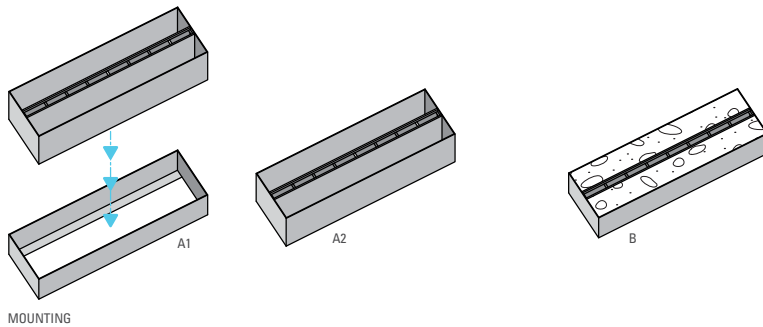

INSPECTION ELEMENT FOR T-SHAPED GRATING - EASY 100

CODE	PRICE €	MATERIAL	VOLUME L x l x h mm	SLOT DIMENSIONS mm	DRAINAGE SURFACE mm	WEIGHT TOTALE Kg
500219		hot galvanised steel DD11 (1.0332) ⁵	H80 500 x 160 x 101,5	491 x 18	1,8	5,70
500231		pickled stainless steel AISI 304 ²	H80 500 x 160 x 101,5	491 x 18	1,8	5,30
500220		hot galvanised steel DD11 (1.0332) ⁵	H120 500 x 160 x 141,5	491 x 18	1,8	7,70
500232		pickled stainless steel AISI 304 ²	H120 500 x 160 x 141,5	491 x 18	1,8	7,10

HOOK FOR TAKING OFF THE GRATING INSPECTION ELEMENT

CODE	PRICE €	MATERIAL	VOLUME L x l x h mm	SLOT DIMENSIONS mm	DRAINAGE SURFACE mm	WEIGHT TOTALE Kg
500254		hot galvanised steel DD11 (1.0332) ⁵	710 x 180	-	-	0,65

2- Classification according to American Standard ASTM.

5- Classification according to Standard EN 10111 (2008) and symbolic designation according to EN 10027-1 (-2) (2006).

N.B. Sizes and weights are subject to usual manufacturing tolerance values.



GRATINGS



**easy
100**

APPLICATIONS OF DUCTILE IRON

- Kerbs
- Historical town centres (slow traffic)
- Parking areas
- Parking decks

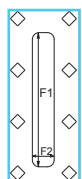

SLOT DETAIL

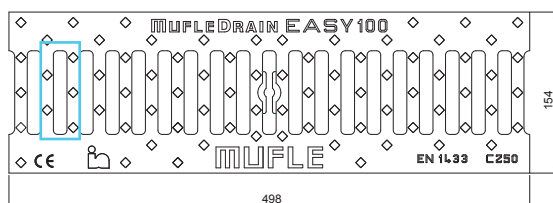

VIEW FROM ABOVE



SIDE VIEW



SLOTTED GRATING 13 mm

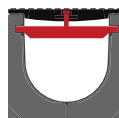

CODE	PRICE €	MATERIAL	DIMENSIONS L x l x h mm	WEIGHT Kg	SECTION DRAINAGE cm ²	OPENINGS F1 X F2 mm	FIXING SYSTEM	
							tie-tod	no fixing
500144		GJS 500/7 ⁶ ductile iron water based paint coated	498 x 154 x 7	4,20	2,10	80,0 x 13,0		up to Class C250 as per Standard EN 1433

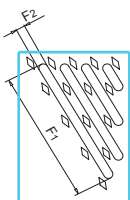

SLOT DETAIL

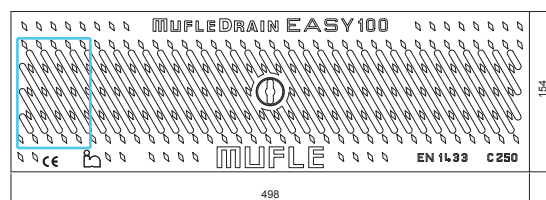

VIEW FROM ABOVE



SIDE VIEW



SLOTTED GRATING 6 mm



CODE	PRICE €	MATERIAL	DIMENSIONS L x l x h mm	WEIGHT Kg	SECTION DRAINAGE cm ²	OPENINGS F1 X F2 mm	FIXING SYSTEM	
							tie-tod	no fixing
500146		GJS 500/7 ⁶ ductile iron water based paint coated	498 x 154 x 7	3,90	1,90	91,5 x 6,0		up to Class C250 as per Standard EN 1433

6- Classification according to Standard EN 1563 (2009).
N.B. Sizes and weights are subject to usual manufacturing tolerance values.



ACCESSORIES

**easy
100**

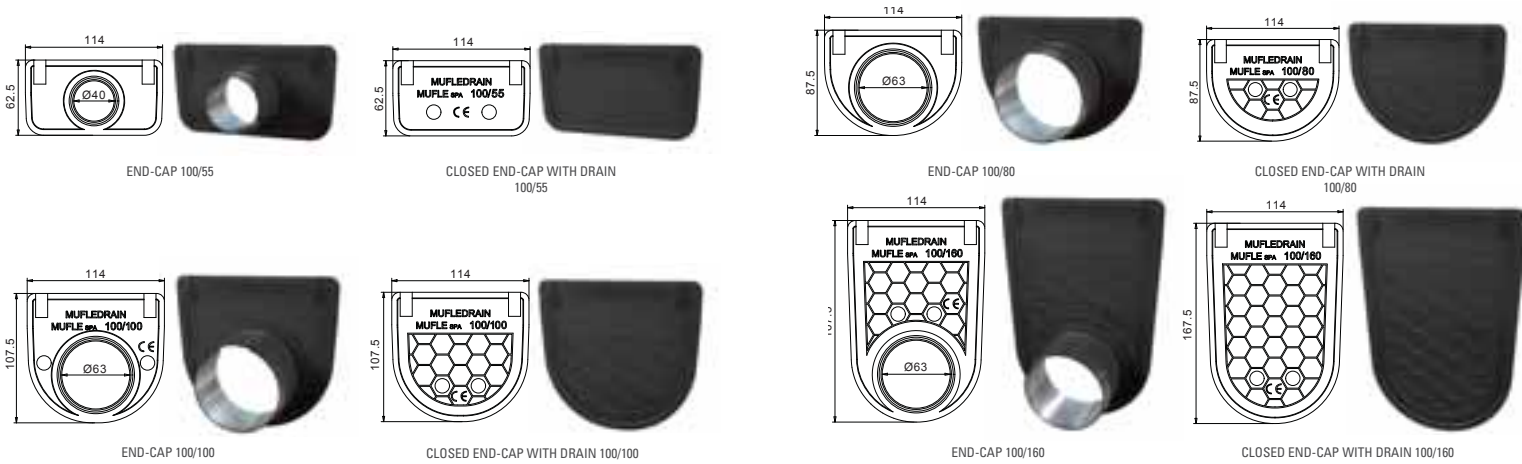

END CAPS

CODE	PRICE	TYPE	MATERIAL	VALID FOR CHANNELS	PREINSTALLED DRAIN
€					
700500		end-cap with drain	PE-HD	100/55	1 x Ø 40
700508		closed end-cap	PE-HD	100/55	-
700501		end-cap with drain	PE-HD	100/80	1 x Ø 63
700509		closed end-cap	PE-HD	100/80	-
700502		end-cap with drain	PE-HD	100/100	1 x Ø 63
700510		closed end-cap	PE-HD	100/100	-
700503		end-cap with drain	PE-HD	100/160	1 x Ø 63
700511		closed end-cap	PE-HD	100/160	-

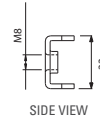
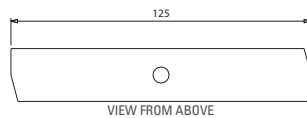

KIT TIE-ROD + SCREWS

CODE	PRICE	MATERIAL	VALID FOR GRATINGS	SCREW	KIT FOR 1ml
€					
500412		galvanised steel	EASY galvanised steel	M8 x 40 TBL combi	2 tie-rods + 2 screws
500413		stainless steel	EASY stainless steel	M8 x 40 TBL combi stainless steel	2 tie-rods + 2 screws
500414		black galvanised steel	EASY ductile iron	M8 x 40 black with hexagonal head	2 tie-rods + 2 screws

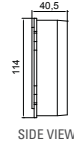
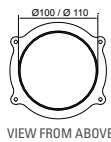

KIT OUTLET + SCREWS

CODE	PRICE	MATERIAL	VALID FOR CHANNELS	DIAMETER	KIT FOR 1 ml
€					
				mm	
506114		PE-HD	100/55 - 100/80	Ø 100	1 outlet Ø 100 + 4 screws
506115		PE-HD	100/55 - 100/80	Ø 110	1 outlet Ø 110 + 4 screws

CONNECTOR FOR STEP-SLOPE

CODE	PRICE	VALID FOR CHANNELS	FAMILIES
€			
700526		from 100/100 to 100/160	EASY - VIP - SMART - SLOPE - WING - PLUS

Utilising Mufle's distinctive step connector system, it is possible to connect drainage channels of differing heights to create greater efficiencies in hydraulic velocity and channel capacity. These efficiencies create benefits in increased drainage performance, outlet number reduction for longer continuous drainage runs, increased self-cleaning ability and lower installation costs. Stepped channel are typically recognised by structured increases in neutral channel depths towards a nominated outlet along a specific drainage channel run/length.

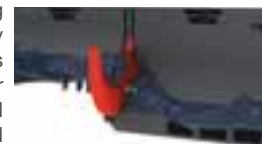

N.B. Sizes and weights are subject to usual manufacturing tolerance values.



SPECIAL PIECES AND DRAIN BOX WITH SYPHON

**easy
100**

LEFT CORNER

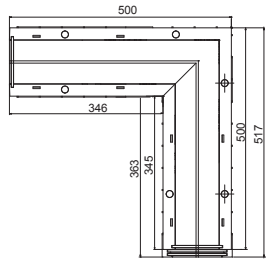

EASY 100

CODE	PRICE €	MODEL
700100		100/160
700101		100/100
700143		100/80
700144		100/55

RIGHT CORNER

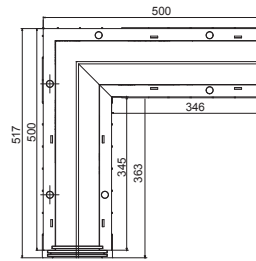

EASY 100

CODE	PRICE €	MODEL
700106		100/160
700107		100/100
700145		100/80
700146		100/55

LEFT TI

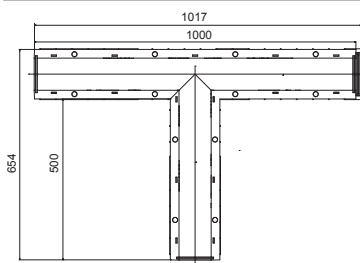

EASY 100

CODE	PRICE €	MODEL
700112		100/160
700113		100/100
700147		100/80
700148		100/55

RIGHT TI

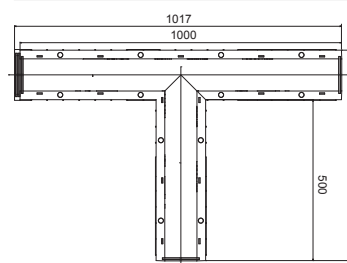

EASY 100

CODE	PRICE €	MODEL
700118		100/160
700119		100/100
700149		100/80
700150		100/55

CROSS

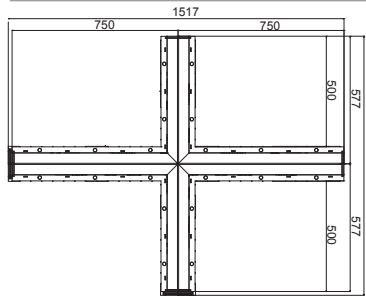

EASY 100

CODE	PRICE €	MODEL
700124		100/160
700125		100/100
700151		100/80
700152		100/55

DRAIN BOX WITH SYPHON

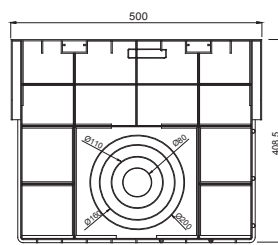

FRONT VIEW

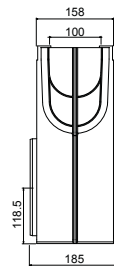

SIDE VIEW

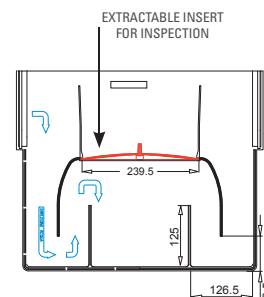

SECTION

EASY 100

CODE	PRICE €	MATERIAL	EXTERNAL DIMENSIONS L x l x h mm	INTERNAL DIMENSIONS L x l x h mm	MAXIMUM LARGE mm	HEIGHT OF OUTLETS mm	WEIGHT Kg	PREINSTALLED DRAIN mm
700008		PE-HD	500 x 158 x 407	500 x 100 x 400	185	118,5	2,50	2 x Ø 110; 2 x Ø 160; 2 x Ø 200

N.B. Sizes and weights are subject to usual manufacturing tolerance values.



150



CHANNELS

**easy
150**

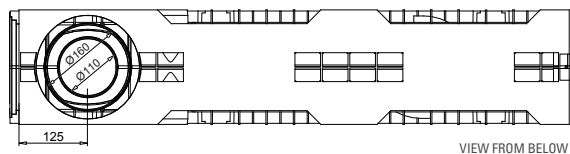

VIEW FROM BELOW

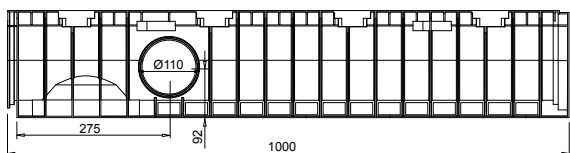

SIDE VIEW

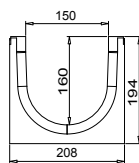

SECTION



EASY 150/160

CODE	PRICE €	MATERIAL	EXTERNAL DIMENSIONS L x l x h mm	INTERNAL DIMENSIONS L x l x h mm	WEIGHT Kg	DRAINAGE SURFACE cm ²	CAPACITY	PREINSTALLED DRAIN mm
700002		PE-HD	1000 x 208 x 194	1000 x 150 x 160	2,85	213,04	21,30	side 2 x Ø 110 bottom 1 x Ø 110; 1 x Ø 160

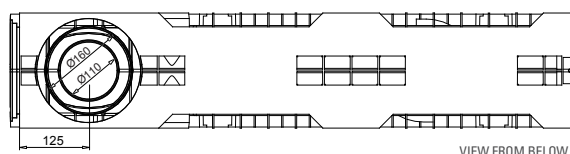

VIEW FROM BELOW

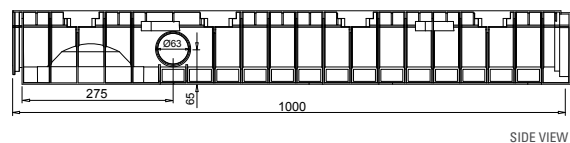

SIDE VIEW

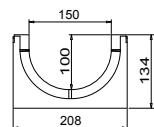

SECTION



EASY 150/100

CODE	PRICE €	MATERIAL	EXTERNAL DIMENSIONS L x l x h mm	INTERNAL DIMENSIONS L x l x h mm	WEIGHT Kg	DRAINAGE SURFACE cm ²	CAPACITY	PREINSTALLED DRAIN mm
700003		PE-HD	1000 x 208 x 134	1000 x 150 x 100	2,30	127,32	12,73	side 2 x Ø 63 bottom 1 x Ø 110; 1 x Ø 160

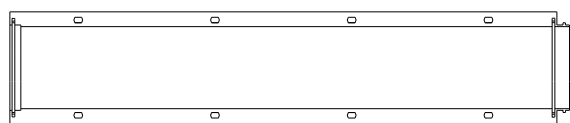

VIEW FROM BELOW

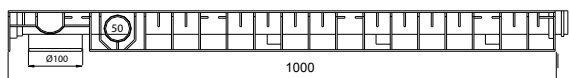

SIDE VIEW

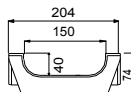

SECTION



EASY 150/40¹⁶

CODE	PRICE €	MATERIAL	EXTERNAL DIMENSIONS L x l x h mm	INTERNAL DIMENSIONS L x l x h mm	WEIGHT Kg	DRAINAGE SURFACE cm ²	CAPACITY	PREINSTALLED DRAIN mm
500004		PE-HD	1000 x 204 x 74	1000 x 150 x 40	1,90	56,50	5,65	side 2 x Ø 50 bottom 1 x Ø 100

16- For the channels 150/40 and 200/40 the grating will be supplied already with holes and the fixing system will be through kit angles. For the item codes please see the price list.
N.B. Waterproofing: in order to ensure the channels are waterproof, a bituminous adhesive sealant should be used. Heat-sealing the channel joints makes sure there will be no leakages through said joints for a very long time. For further information please contact MufleSystem's Technical Department.
N.B. Sizes and weights are subject to usual manufacturing tolerance values.



GRATINGS



A 15

**easy
150**

APPLICATIONS OF GALVANISED STEEL

Green areas and parks
Pedestrian areas and/or cycle lanes
Sports facilities
Terraces

APPLICATIONS OF STAINLESS STEEL

Green areas and parks
Pedestrian areas and/or cycle lanes
Sports facilities
Terraces
Kitchens in hospitals, restaurants and similar facilities

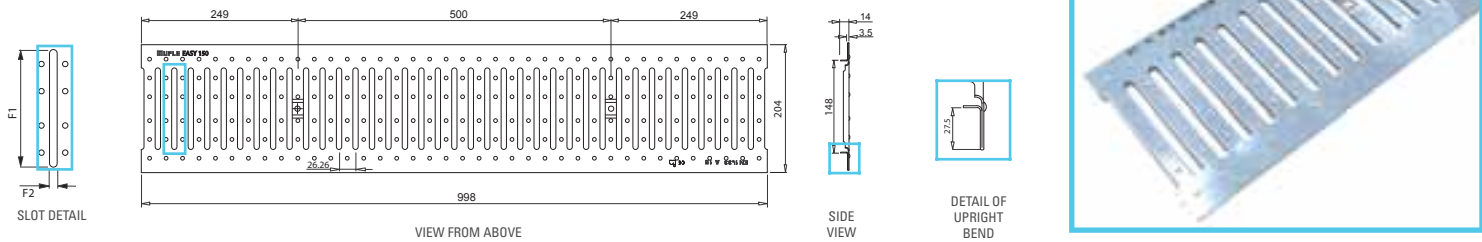

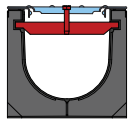
SLOTTED GRATING								14 mm	
CODE	PRICE	MATERIAL	DIMENSIONS L x l x h	WEIGHT	DRAINAGE SECTION	OPENINGS F1 X F2	FIXING SYSTEM		
	€		mm	Kg	cm ²	mm	tie-tod	no fixing	
500123		galvanised steel DX51D ³	998 x 204 x 3,5	3,30	4,20	130,0 x 8,5		up to Class C250 as per Standard EN 1433	
500124		pickled stainless steel AISI 304 ²							
500184		galvanised steel DX51D ³	498 x 204 x 3,5	1,65	2,10				
500185		pickled stainless steel AISI 304 ²							

2- Classification according to American Standard ASTM.

3- Classification according to Standard EN 10142 (2002) and symbolic designation according to EN 10027-1 (-2) (2006).

N.B. Sizes and weights are subject to usual manufacturing tolerance values.



GRATINGS

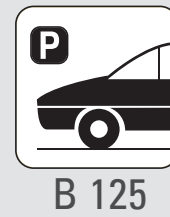

**easy
150**

APPLICATIONS OF GALVANISED STEEL

Pavements
Lay-bys and private car parks

APPLICATIONS OF STAINLESS STEEL

Pavements
Lay-bys and private car parks
Food factories
Chemically aggressive environments

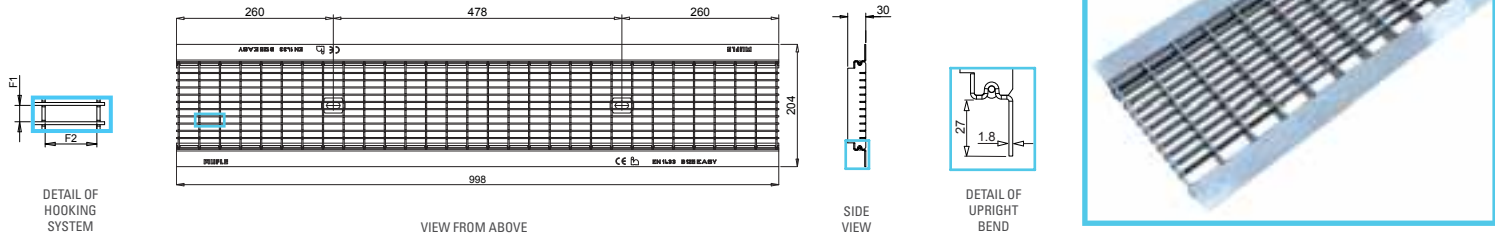

ANTI-HEEL MESH GRATING



CODE	PRICE €	MATERIAL	DIMENSIONS L x l x h mm	WEIGHT Kg	DRAINAGE SECTION cm ²	OPENINGS F1 X F2 mm	FIXING SYSTEM	
							tie-tod	no fixing
500117		hot dip galvanised steel DD11 (1.0332) ⁵	998 x 204 x 1,8	5,40	10,50	10,2 x 32,2		up to Class C250 as per Standard EN 1433
500119		pickled stainless steel AISI 304 ²						
500178		hot dip galvanised steel DD11 (1.0332) ⁵	498 x 204 x 1,8	2,70	5,25			
500180		pickled stainless steel AISI 304 ²						

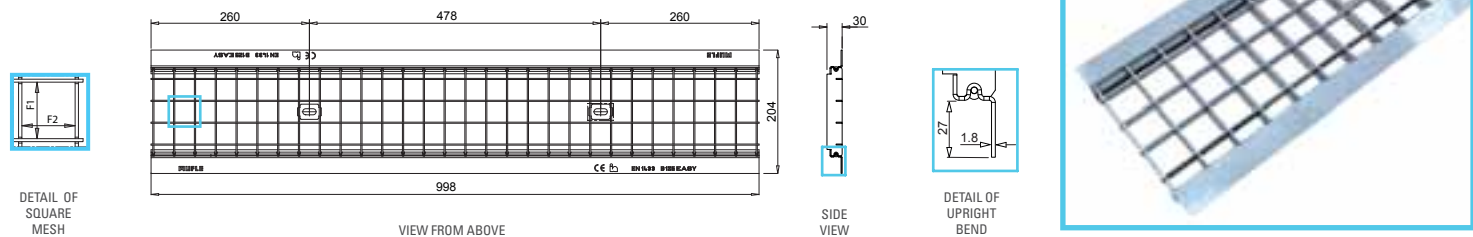

SQUARE MESH GRATING



CODE	PRICE €	MATERIAL	DIMENSIONS L x l x h mm	WEIGHT Kg	DRAINAGE SECTION cm ²	OPENINGS F1 X F2 mm	FIXING SYSTEM	
							tie-tod	no fixing
500120		hot dip galvanised steel DD11 (1.0332) ⁵	998 x 204 x 1,8	4,60	12,77	34,2 x 32,2		up to Class C250 as per Standard EN 1433
500122		pickled stainless steel AISI 304 ²						
500181		hot dip galvanised steel DD11 (1.0332) ⁵	498 x 204 x 1,8	2,30	6,38			
500183		pickled stainless steel AISI 304 ²						

2- Classification according to American Standard ASTM.

5- Classification according to Standard EN 10111 (2008) and symbolic designation according to EN 10027-1 (-2) (2006).

N.B. Sizes and weights are subject to usual manufacturing tolerance values.



GRATINGS

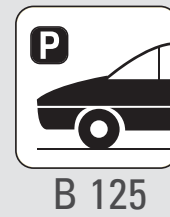

**easy
150**

APPLICATIONS OF DUCTILE IRON

Pavements
Lay-bys and private car parks



SLOT DETAIL

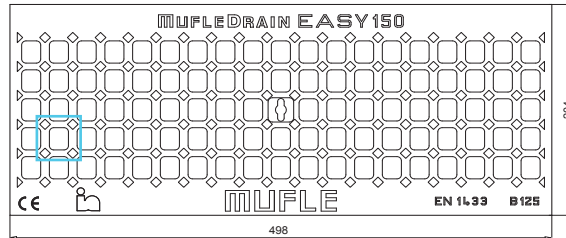

VIEW FROM ABOVE

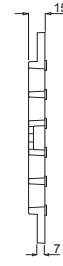

SIDE VIEW



MESH GRATING								15 mm	
CODE	PRICE	MATERIAL	DIMENSIONS L x l x h	WEIGHT	DRAINAGE SURFACE	OPENINGS F1 x F2	FIXING SYSTEM		
	€		mm	kg	dm ²	mm	tie-tod	no fixing	
500149		GJS 500/7 ⁶ ductile iron water based paint coated	498 x 204 x 7	4,70	3,58	21,5 x 17,5		up to Class C250 as per Standard EN 1433	

6- Classification according to Standard EN 1563 (2009).
N.B. Sizes and weights are subject to usual manufacturing tolerance values.



SLOTTED GRATINGS T

TYPE C 250
MIDDLE
DRIVEWAY

**easy
150**

APPLICATIONS OF GALVANISED STEEL

Low visual impact drainage in public and private places:
Pedestrian areas
Private car parks or multi-level car parks
Roads subjected to middle loads (urban speed ≤ 40 km/h)
Areas not subjected to dock movements

APPLICATIONS OF STAINLESS STEEL

Low visual impact drainage in public and private places:
Pedestrian areas
Private car parks or multi-level car parks
Roads subjected to middle loads (urban speed ≤ 40 km/h)
Areas not subjected to dock movements

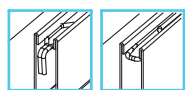

DETAIL OF
HOOKING
SYSTEM⁸

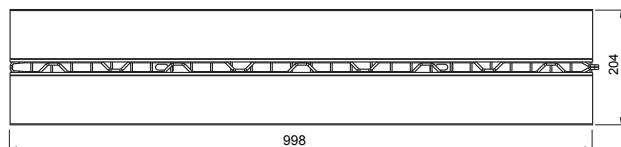

VIEW FROM ABOVE

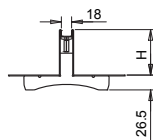

SIDE VIEW

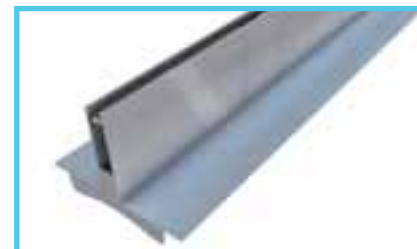

T-SHAPED GRATING

CODE	PRICE €	MATERIAL	DIMENSIONS L x l x h mm	HEIGHT OF SLOTS H mm	WEIGHT Kg	SECTION DRAINAGE cm ²	OPENINGS F1 x F2 mm
500208		hot dip galvanised steel DD11 (1.0332) ⁵	998 x 204 x 106,5	80	5,60	1,80	998 x 18
500244		pickled stainless steel AISI 304 ²					
500209		hot dip galvanised steel DD11 (1.0332) ⁵	998 x 204 x 146,5	120	6,60	1,80	
500245		pickled stainless steel AISI 304 ²					

2- Classification according to American Standard ASTM.

5- Classification according to Standard EN 10111 (2008) and symbolic designation according to EN 10027-1 (-2) (2006).

8- Hooking System between the gratings through hooks and holes.

N.B. Sizes and weights are subject to usual manufacturing tolerance values.



INSPECTION ELEMENT FOR T-SHAPED GRATING

TYPE C 250
MIDDLE
DRIVEWAY

**EASY
150**

CONTAINMENT TANK

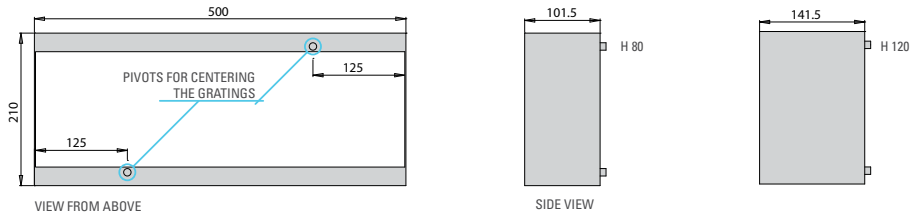

The inspection element for the T-shaped gratings shall be assembled together with the drain box with siphon EASY in HD-PE as showed in the picture. Please see page 54 for the details of the drain box with siphon.

INSPECTION GRATING

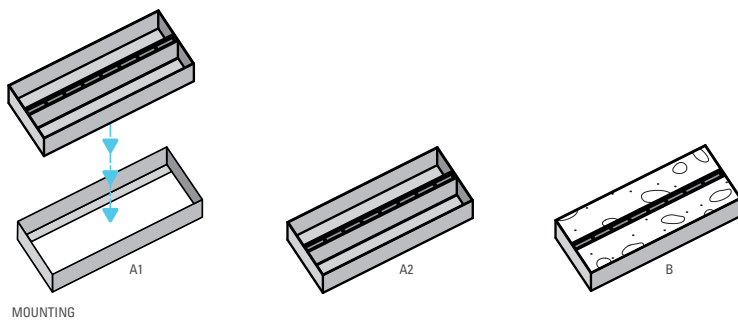
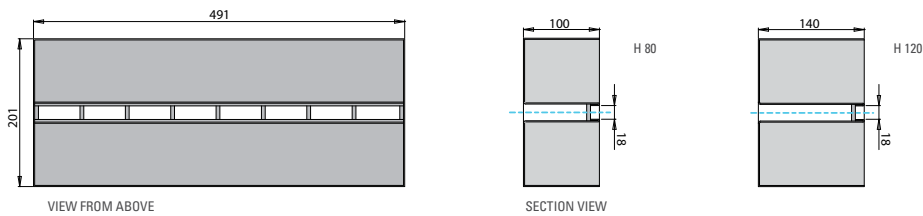

INSPECTION ELEMENT FOR T-SHAPED GRATING - EASY 150

CODE	PRICE €	MATERIAL	VOLUME L x l x h mm	SLOT DIMENSIONS mm	DRAINAGE SURFACE mm	WEIGHT TOTALE Kg
500221		hot dip galvanised steel DD11 (1.0332) ⁵	H80 500 x 210 x 101,5	491 x 18	1,8	6,40
500233		pickled stainless steel AISI 304 ²	H80 500 x 210 x 101,5	491 x 18	1,8	5,90
500222		hot dip galvanised steel DD11 (1.0332) ⁵	H120 500 x 210 x 141,5	491 x 18	1,8	8,20
500234		pickled stainless steel AISI 304 ²	H120 500 x 210 x 141,5	491 x 18	1,8	7,70

HOOK FOR TAKING OFF THE GRATING INSPECTION ELEMENT

CODE	PRICE €	MATERIAL	VOLUME L x l x h mm	SLOT DIMENSIONS mm	DRAINAGE SURFACE mm	WEIGHT TOTALE Kg
500254		hot dip galvanised steel DD11 (1.0332) ⁵	710 x 180	-	-	0,65

2- Classification according to American Standard ASTM.

5- Classification according to Standard EN 10111 (2008) and symbolic designation according to EN 10027-1 (-2) (2006).

N.B. Sizes and weights are subject to usual manufacturing tolerance values.



GRATINGS



**easy
150**

APPLICATIONS OF DUCTILE IRON

- Kerbs
- Historical town centres (slow traffic)
- Parking areas
- Parking decks

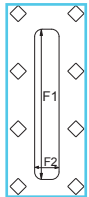

SLOT DETAIL

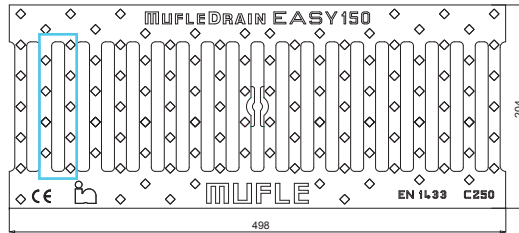



VIEW FROM ABOVE



SIDE VIEW



SLOTTED GRATING 13 mm								 20 mm	
CODE	PRICE	MATERIAL	DIMENSIONS L x l x h	WEIGHT	DRAINAGE SECTION	OPENINGS F1 X F2	FIXING SYSTEM		
	€		mm	Kg	cm ²	mm	tie-tod	no fixing	
500151		GJS 500/7 ⁶ ductile iron water based paint coated	498 x 204 x 7	5,50	3,38	130,0 x 13,0		up to Class C250 as per Standard EN 1433	

6- Classification according to Standard EN 1563 (2009).
N.B. Sizes and weights are subject to usual manufacturing tolerance values.



ACCESSORIES

**easy
150**

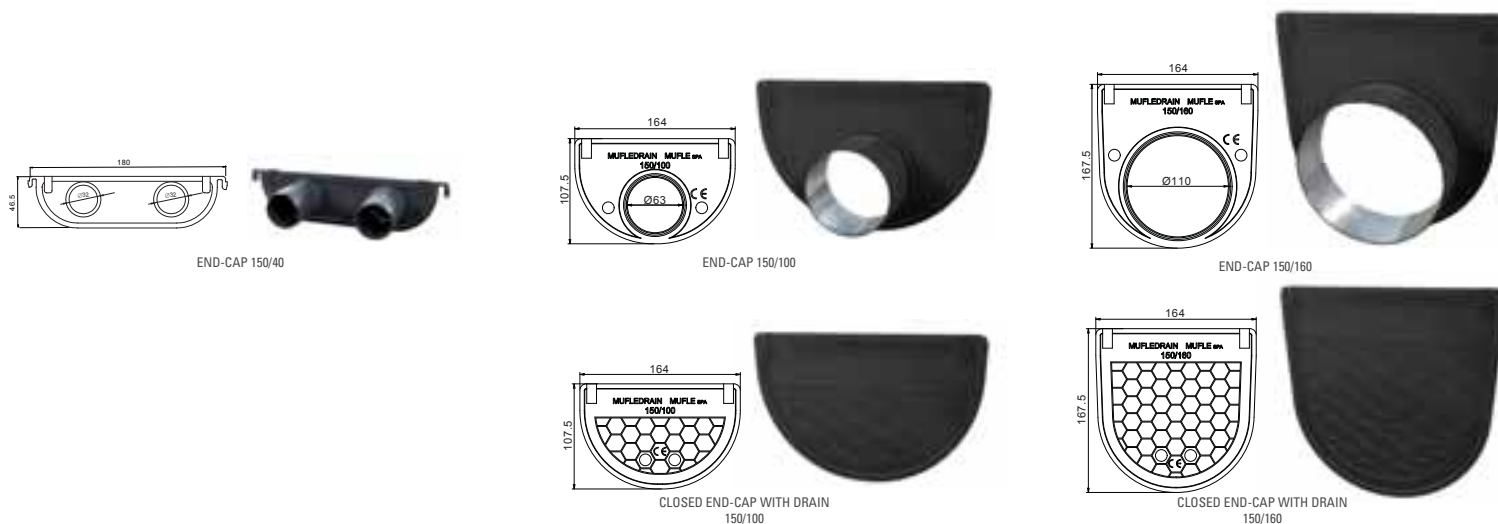

END CAPS

CODE	PRICE €	TYPE	MATERIAL	VALID FOR CHANNELS	PREINSTALLED DRAINS mm
500518		closed end-cap with preinstalled drain	PE-HD	150/40	2 x Ø 32
700504		end-cap with drain	PE-HD	150/100	1 x Ø 63
700512		closed end-cap	PE-HD	150/100	-
700505		end-cap with drain	PE-HD	150/160	1 x Ø 110
700513		closed end-cap	PE-HD	150/160	-

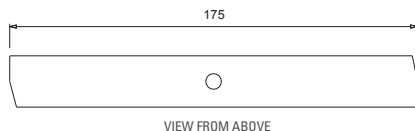

VIEW FROM ABOVE

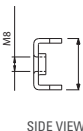

SIDE VIEW



KIT TIE-ROD + SCREWS

CODE	PRICE €	MATERIAL	VALID FOR GRATINGS	SCREW	KIT FOR 1ml
500415		galvanised steel	EASY galvanised steel	M8 x 40 TBL combi	2 tie-rods + 2 screws
500416		stainless steel	EASY stainless steel	M8 x 40 TBL combi	2 tie-rods + 2 screws
500417		black galvanised steel	EASY ductile iron	M8 x 40 black with hexagonal head	2 tie-rods + 2 screws

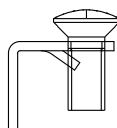

KIT ANGLE + SCREWS

CODE	PRICE €	MATERIAL	VALID FOR GRATINGS	VALID FOR CHANNELS	KIT FOR 1ml
500400		galvanised steel	EASY galvanised steel	EASY 100/40	4 angle + 4 screws
500401		stainless steel	EASY stainless steel		4 angle + 4 screws
500402		black galvanised steel	EASY ductile iron		8 angle + 8 screws

CONNECTOR FOR STEP-SLOPE

CODE	PRICE €	VALID FOR CHANNELS	FAMILIES
700517		from 150/100 to 150/160	EASY - VIP - SMART - SLOPE - WING - PLUS

Utilising Mufle's distinctive step connector system, it is possible to connect drainage channels of differing heights to create greater efficiencies in hydraulic velocity and channel capacity. These efficiencies create benefits in increased drainage performance, outlet number reduction for longer continuous drainage runs, increased self cleansing ability and lower installation costs. Stepped channel are typically recognised by structured increases in neutral channel depths towards a nominated outlet along a specific drainage channel run/length.



N.B. Sizes and weights are subject to usual manufacturing tolerance values.



SPECIAL PIECES AND DRAIN BOX WITH SYPHON

**easy
150**

LEFT CORNER

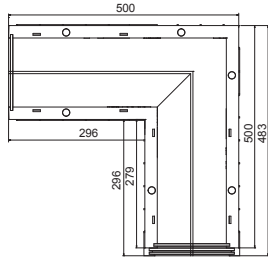

EASY 150

CODE	PRICE €	MODEL
700102		150/160
700103		150/100
500305		150/40

RIGHT CORNER

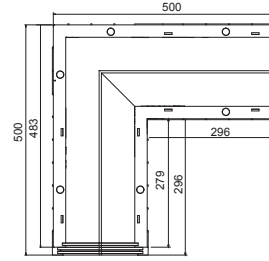

EASY 150

CODE	PRICE €	MODEL
700108		150/160
700109		150/100
500314		150/40

LEFT TI

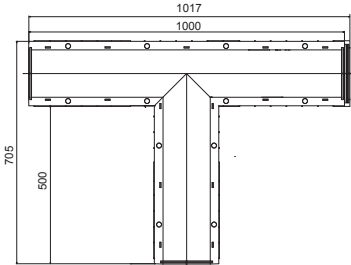

EASY 150

CODE	PRICE €	MODEL
700114		150/160
700115		150/100
500323		150/40

RIGHT TI

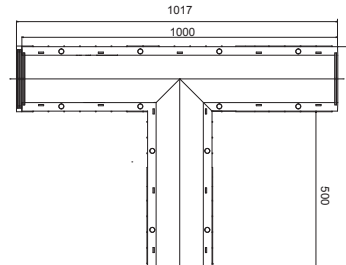

EASY 150

CODE	PRICE €	MODEL
700120		150/160
700121		150/100
500332		150/40

CROSS

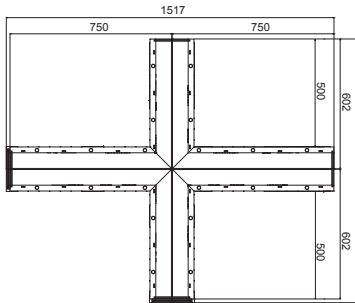

EASY 150

CODE	PRICE €	MODEL
700126		150/160
700127		150/100
500341		150/40

DRAIN BOX WITH SYPHON⁹

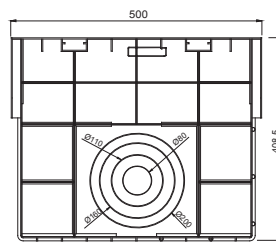

FRONT VIEW

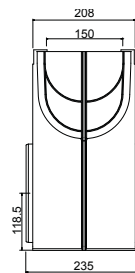

SIDE VIEW

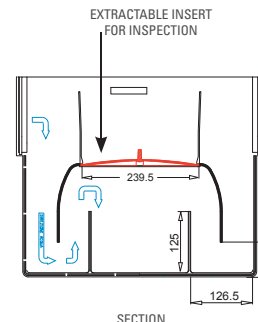

SECTION

EASY 150

CODE	PRICE €	MATERIAL	EXTERNAL DIMENSIONS L x l x h mm	INTERNAL DIMENSIONS L x l x h mm	MAXIMUM LARGE mm	HEIGHT OF OUTLETS mm	WEIGHT Kg	PREINSTALLED DRAIN mm
700009		PE-HD	500 x 208 x 407	500 x 150 x 400	235	118,5	2,78	2 x Ø 110; 2 x Ø 160; 2 x Ø 200

9- The drain box Easy, Vip and Wing 150 and 200 are not prearranged to be connected to the correspondent channels Easy, Wing and Vip 150/40, 200/40
N.B. Sizes and weights are subject to usual manufacturing tolerance values.



mm



CHANNELS

**easy
200**

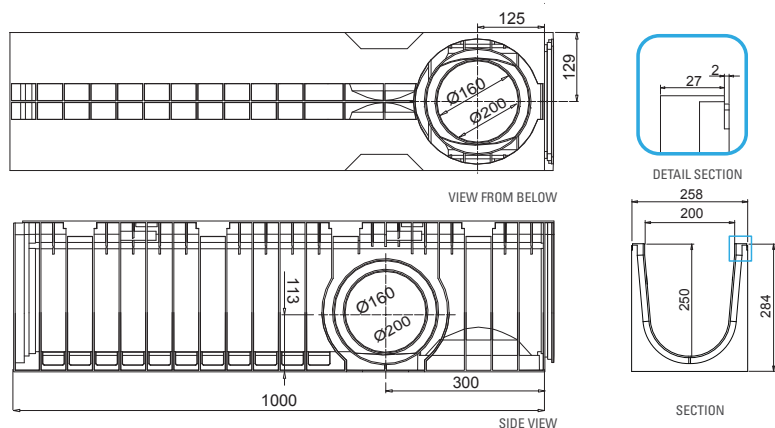

EASY 200/250								
CODE	PRICE	MATERIAL	EXTERNAL DIMENSIONS L x l x h	INTERNAL DIMENSIONS L x l x h	WEIGHT	DRAINAGE SURFACE	CAPACITY	PREINSTALLED DRAIN
	€		mm	mm	Kg	cm ²		mm
500013		PE-HD	1000 x 258 x 284	1000 x 200 x 250	4,60	430,00	43,00	side 2 x Ø 160; 2 Ø 200 bottom 1 x Ø 160; 1 x Ø 200

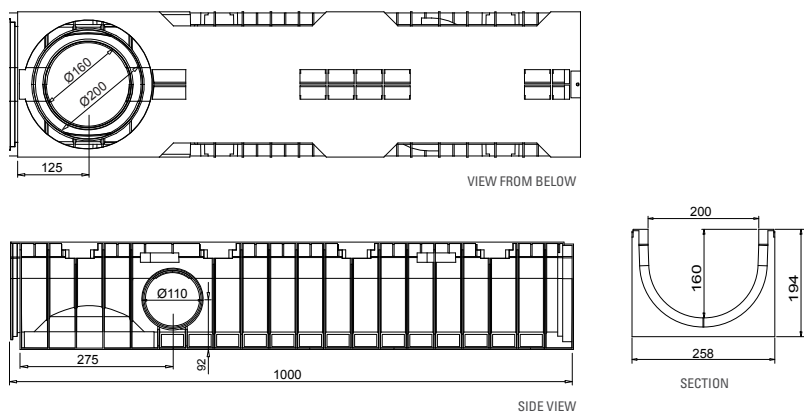

EASY 200/160								
CODE	PRICE	MATERIAL	EXTERNAL DIMENSIONS L x l x h	INTERNAL DIMENSIONS L x l x h	WEIGHT	DRAINAGE SURFACE	CAPACITY	PREINSTALLED DRAIN
	€		mm	mm	Kg	cm ²		mm
700004		PE-HD	1000 x 258 x 194	1000 x 200 x 160	3,25	275,87	27,58	side 2 x Ø 110 bottom 1 x Ø 200; 1 x Ø 160

16- For the channels 150/40 and 200/40 the grating will be supplied already with holes and the fixing system will be through kit angles. For the item codes please see the price list.
 N.B. Waterproofing: in order to ensure the channels are waterproof, a bituminous adhesive sealant should be used. Heat-sealing the channel joints makes sure there will be no leakages through said joints for a very long time. For further information please contact MufleSystem's Technical Department.
 N.B. Sizes and weights are subject to usual manufacturing tolerance values.



CHANNELS

**easy
200**

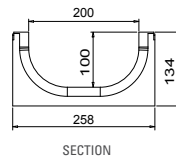
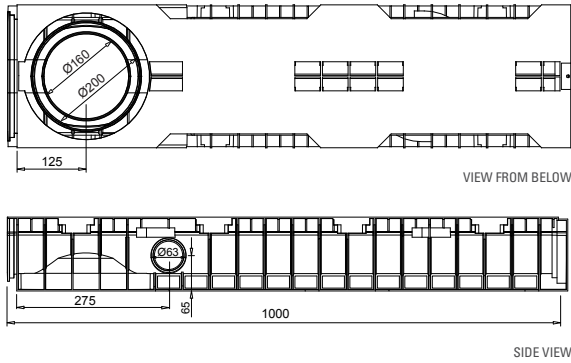

EASY 200/100								
CODE	PRICE	MATERIAL	EXTERNAL DIMENSIONS L x l x h	INTERNAL DIMENSIONS L x l x h	WEIGHT	DRAINAGE SURFACE	CAPACITY	PREINSTALLED DRAIN
	€		mm	mm	Kg	cm ²		mm
700005		PE-HD	1000 x 258 x 134	1000 x 200 x 100	2,65	178,73	17,87	side 2 x Ø 63 bottom 1 x Ø 200; 1 x Ø 160

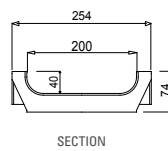
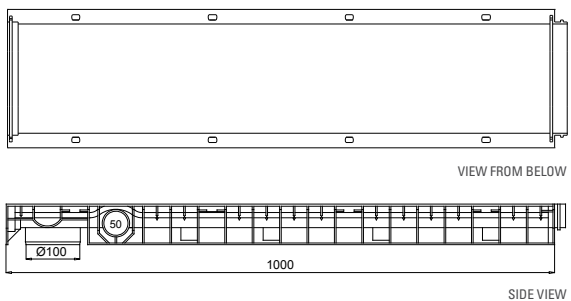

EASY 200/40 ¹⁶								
CODE	PRICE	MATERIAL	EXTERNAL DIMENSIONS L x l x h	INTERNAL DIMENSIONS L x l x h	WEIGHT	DRAINAGE SURFACE	CAPACITY	PREINSTALLED DRAIN
	€		mm	mm	Kg	cm ²		mm
500007		PE-HD	1000 x 254 x 74	1000 x 200 x 40	2,10	76,50	7,65	side 2 x Ø 50 bottom 1 x Ø 100

16- For the channels 150/40 and 200/40 the grating will be supplied already with holes and the fixing system will be through kit angles. For the item codes please see the price list.
N.B. Waterproofing: in order to ensure the channels are waterproof, a bituminous adhesive sealant should be used. Heat-sealing the channel joints makes sure there will be no leakages through said joints for a very long time. For further information please contact MufleSystem's Technical Department.
N.B. Sizes and weights are subject to usual manufacturing tolerance values.



GRATINGS



**easy
200**

APPLICATIONS OF GALVANISED STEEL

- Green areas and parks
- Pedestrian areas and/or cycle lanes
- Sports facilities
- Terraces

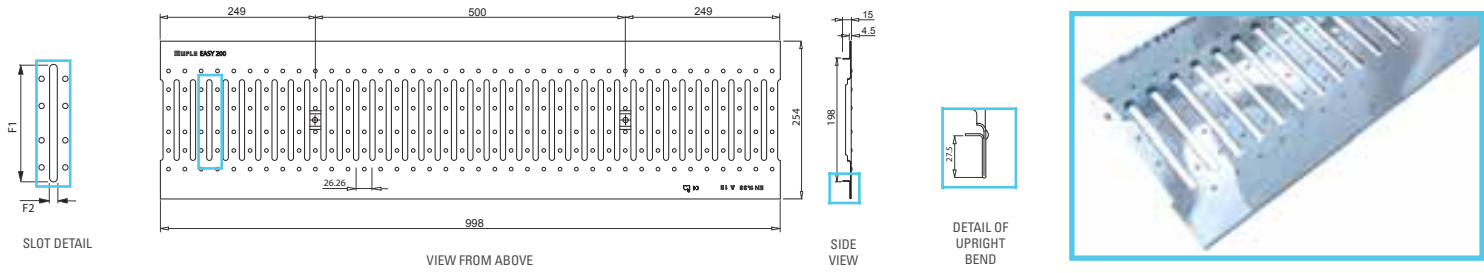

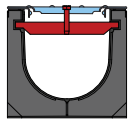
SLOTTED GRATING								 15 mm	
CODE	PRICE	MATERIAL	DIMENSIONS L x l x h	WEIGHT	DRAINAGE SECTION	OPENINGS F1 X F2	FIXING SYSTEM		
	€		mm	Kg	cm ²	mm	tie-tod	no fixing	
500135		galvanised steel DX51D ³	998 x 254 x 4,5	5,20	4,20	130,0 x 8,5		up to Class C250 as per Standard EN 1433	
500196		galvanised steel DX51D ³	498 x 254 x 4,5	2,60	2,10				

3- Classification according to Standard EN 10142 (2002) and symbolic designation according to EN 10027-1 (-2) (2006).
N.B. Sizes and weights are subject to usual manufacturing tolerance values.



GRATINGS

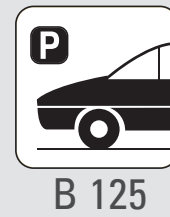

easy
200

APPLICATIONS OF GALVANISED STEEL

Pavements
Lay-bys and private car parks

APPLICATIONS OF STAINLESS STEEL

Pavements
Lay-bys and private car parks
Food factories
Chemically aggressive environments

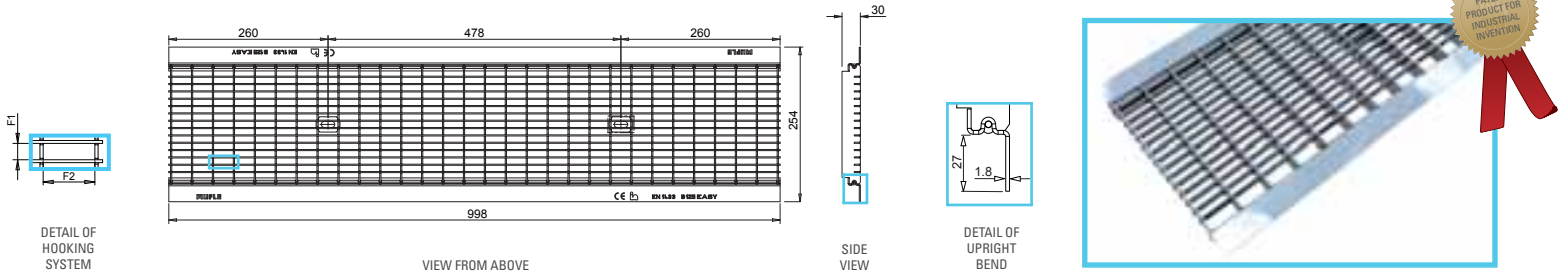

ANTI-HELL MESH GRATING								30 mm	
CODE	PRICE €	MATERIAL	DIMENSIONS L x l x h mm	WEIGHT Kg	DRAINAGE SECTION cm ²	OPENINGS F1 X F2 mm	FIXING SYSTEM		
							tie-tod	no fixing	
500131		hot dip galvanised steel DD11 (1.0332) ⁵	998 x 254 x 1,8	6,60	14,00	10,2 x 32,2		up to Class C250 as per Standard EN 1433	
500132		pickled stainless steel AISI 304 ²							
500192		hot dip galvanised steel DD11 (1.0332) ⁵	498 x 254 x 1,8	3,30	7,00				
500193		pickled stainless steel AISI 304 ²							

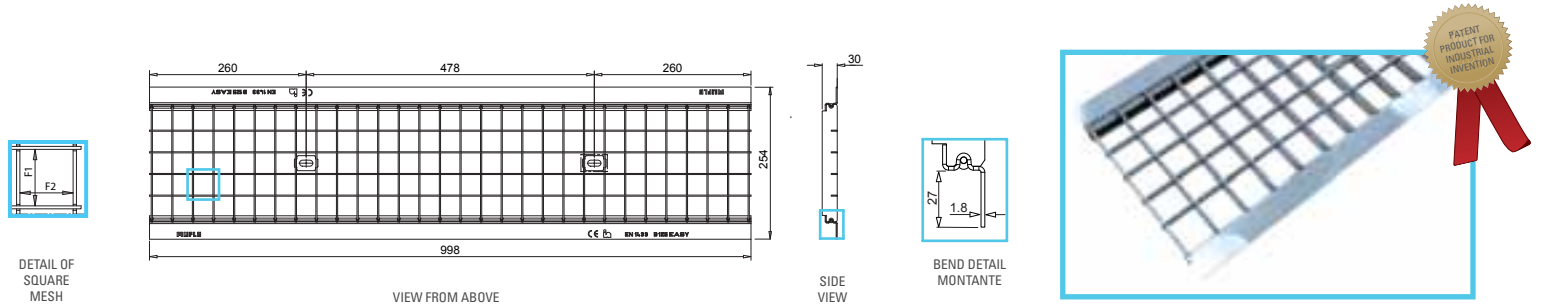

SQUARE MESH GRATING								30 mm	
CODE	PRICE €	MATERIAL	DIMENSIONS L x l x h mm	WEIGHT Kg	DRAINAGE SECTION cm ²	OPENINGS F1 X F2 mm	FIXING SYSTEM		
							tie-tod	no fixing	
500133		hot dip galvanised steel DD11 (1.0332) ⁵	998 x 254 x 1,8	5,20	16,00	34,2 x 32,2		up to Class C250 as per Standard EN 1433	
500134		pickled stainless steel AISI 304 ²							
500194		hot dip galvanised steel DD11 (1.0332) ⁵	498 x 254 x 1,8	2,60	8,00				
500195		pickled stainless steel AISI 304 ²							

2- Classification according to American Standard ASTM.
5- Classification according to Standard EN 10111 (2008) and symbolic designation according to EN 10027-1 (-2) (2006).
N.B. Sizes and weights are subject to usual manufacturing tolerance values.



GRATINGS

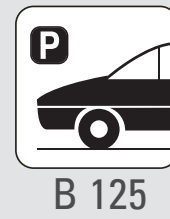

**easy
200**

APPLICATIONS OF DUCTILE IRON

Pavements
Lay-bys and private car parks



SLOT DETAIL

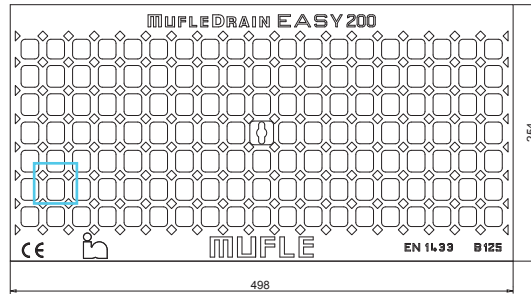



VIEW FROM ABOVE

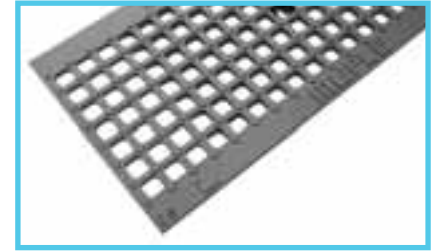

SIDE VIEW

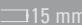

MESH GRATING								 15 mm  15 mm	
CODE	PRICE	MATERIAL	DIMENSIONS L x l x h	WEIGHT	DRAINAGE SECTION	OPENINGS F1 X F2	FIXING SYSTEM		
	€		mm	Kg	cm ²	mm	tie-tod	no fixing	
500154		GJS 500/7 ⁶ ductile iron water based paint coated	498 x 254 x 7	5,85	5,00	21,5 x 17,5		up to Class C250 as per Standard EN 1433	

6- Classification according to Standard EN 1563 (2009).
N.B. Sizes and weights are subject to usual manufacturing tolerance values.



SLOTTED GRATINGS T

TYPE C 250
MIDDLE
DRIVEWAY

**easy
200**

APPLICATIONS OF GALVANISED STEEL

Low visual impact drainage in public and private places:
Pedestrian areas
Private car parks or multi-level car parks
Roads subjected to middle loads (urban speed ≤ 40 km/h)
Areas not subjected to dock movements

APPLICATIONS OF STAINLESS STEEL

Low visual impact drainage in public and private places:
Pedestrian areas
Private car parks or multi-level car parks
Roads subjected to middle loads (urban speed ≤ 40 km/h)
Areas not subjected to dock movements

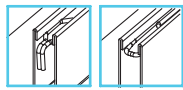

DETAIL OF
HOOKING
SYSTEM 8⁸

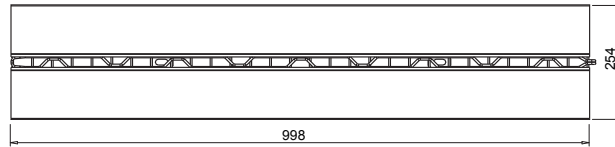

VIEW FROM ABOVE

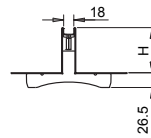

SIDE VIEW

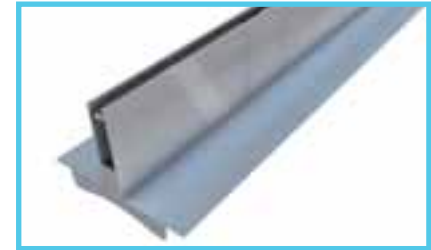

T-SHAPED GRATING

CODE	PRICE	MATERIAL	DIMENSIONS L x l x h	HEIGHT OF SLOTS H	WEIGHT	SECTION DRAINAGE	OPENINGS F1 x F2
	€		mm	mm	Kg	cm ²	mm
500210		hot dip galvanised steel DD11 (1.0332) ⁵	998 x 254 x 106,5	80	6,30	1,80	998 x 18
500246		pickled stainless steel AISI 304 ²					
500211		hot dip galvanised steel DD11 (1.0332) ⁵	998 x 254 x 146,5	120	7,40	1,80	
500247		pickled stainless steel AISI 304 ²					

2- Classification according to American Standard ASTM.

5- Classification according to Standard EN 10111 (2008) and symbolic designation according to EN 10027-1 (-2) (2006).

8- Hooking System between the gratings through hooks and holes.

N.B. Sizes and weights are subject to usual manufacturing tolerance values.



INSPECTION ELEMENT FOR T-SHAPED GRATING

TYPE C 250
MIDDLE
DRIVEWAY

**EASY
200**

CONTAINMENT TANK

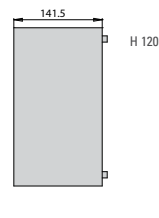
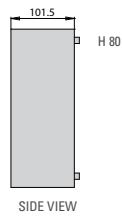
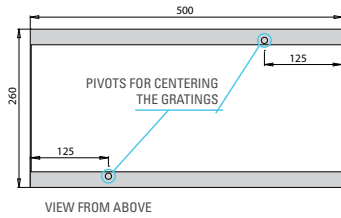

INSPECTION GRATING

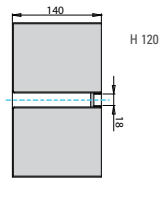
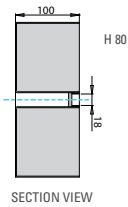
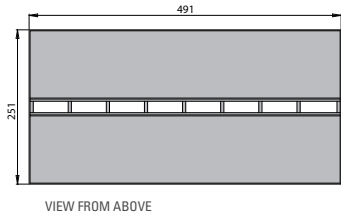

The inspection element for the T-shaped gratings shall be assembled together with the drain box with siphon EASY in HD-PE as showed in the picture. Please see page 64 for the details of the drain box with siphon.

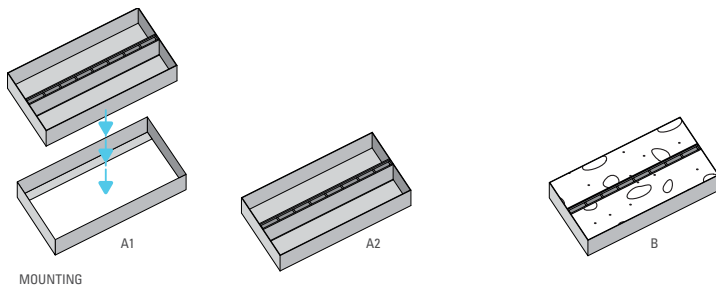

INSPECTION ELEMENT FOR T-SHAPED GRATING - EASY 200

CODE	PRICE €	MATERIAL	VOLUME L x l x h mm	SLOT DIMENSIONS mm	DRAINAGE SURFACE mm	WEIGHT TOTALE Kg
500223		hot dip galvanised steel DD11 (1.0332) ⁵	H80 500 x 260 x 101,5	491 x 18	1,8	6,90
500235		pickled stainless steel AISI 304 ²	H80 500 x 260 x 101,5	491 x 18	1,8	6,40
500224		hot dip galvanised steel DD11 (1.0332) ⁵	H120 500 x 260 x 141,5	491 x 18	1,8	9,00
500236		pickled stainless steel AISI 304 ²	H120 500 x 260 x 141,5	491 x 18	1,8	8,30

HOOK FOR TAKING OFF THE GRATING INSPECTION ELEMENT

CODE	PRICE €	MATERIAL	VOLUME L x l x h mm	SLOT DIMENSIONS mm	DRAINAGE SURFACE mm	WEIGHT TOTALE Kg
500254		hot dip galvanised steel DD11 (1.0332) ⁵	710 x 180	-	-	0,65

2- Classification according to American Standard ASTM.

5- Classification according to Standard EN 10111 (2008) and symbolic designation according to EN 10027-1 (-2) (2006).

N.B. Sizes and weights are subject to usual manufacturing tolerance values.



GRATINGS



**easy
200**

APPLICATIONS OF DUCTILE IRON

- Kerbs
- Historical town centres (slow traffic)
- Parking areas
- Parking decks

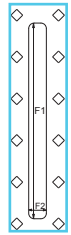

SLOT DETAIL

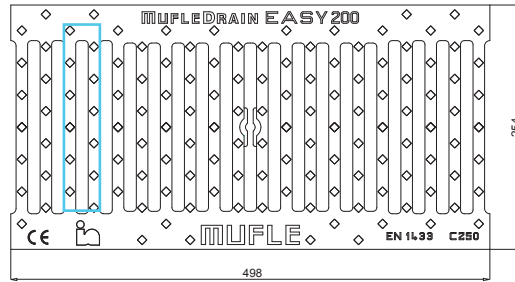

VIEW FROM ABOVE



SIDE VIEW



SLOTTED GRATING 13 mm



CODE	PRICE €	MATERIAL	DIMENSIONS L x l x h mm	WEIGHT Kg	DRAINAGE SECTION cm ²	OPENINGS F1 X F2 mm	FIXING SYSTEM	
							tie-tod	no fixing
500155		GJS 500/7 ⁶ ductile iron water based paint coated	498 x 254 x 7	7,20	4,68	180,0 x 13,0		up to Class C250 as per Standard EN 1433

6- Classification according to Standard EN 1563 (2009).
N.B. Sizes and weights are subject to usual manufacturing tolerance values.



ACCESSORIES

**easy
200**

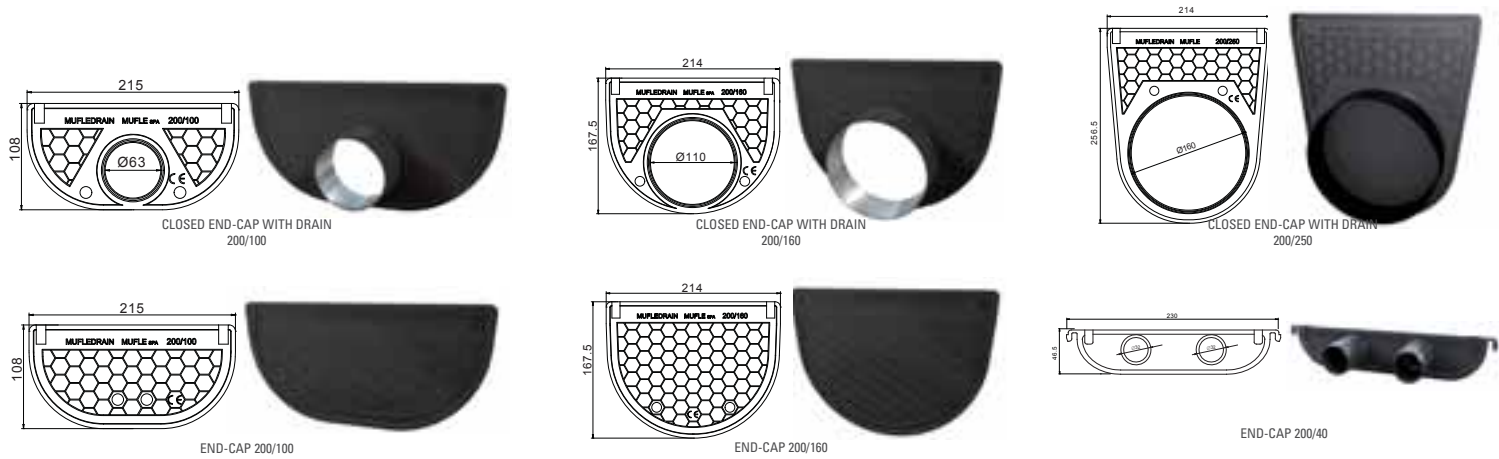

END CAPS

CODE	PRICE €	TYPE	MATERIAL	VALID FOR CHANNELS	PREINSTALLED DRAIN
500521		end-cap with drain	PE-HD	200/40	2 x Ø 32
700506		end-cap with drain	PE-HD	200/100	1 x Ø 63
700514		closed end-cap	PE-HD	200/100	-
700507		end-cap with drain	PE-HD	200/160	1 x Ø 110
700515		closed end-cap	PE-HD	200/160	-
502416		closed end cap with preformed outlet	PE-HD	200/250	1 x Ø 160

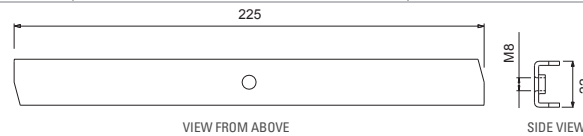

KIT TIE-ROD + SCREWS

CODE	PRICE €	MATERIAL	VALID FOR GRATINGS	SCREW	KIT FOR 1 ml
500418		galvanised steel	EASY galvanised steel	M8 x 40 TBL combi	2 tie-rods + 2 screws
500419		stainless steel	EASY stainless steel	M8 x 40 TBL combi	2 tie-rods + 2 screws
500420		black galvanised steel	EASY ductile iron	M8 x 40 black with hexagonal head	2 tie-rods + 2 screws

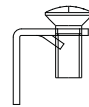

CORNER KIT + SCREWS

CODE	PRICE €	MATERIAL	VALID FOR GRATINGS	VALID FOR CHANNELS	KIT FOR 1ml
500400		galvanised steel	EASY galvanised steel	EASY 100/40	4 angle + 4 screws
500401		stainless steel	EASY stainless steel		4 angle + 4 screws
500402		black galvanised steel	EASY ductile iron		8 angle + 8 screws

CONNECTOR FOR STEP-SLOPE

CODE	PRICE €	VALID FOR CHANNELS	FAMILIES
700518		from 200/160 to 200/250	VIP - SLOPE - WING
700519		from 200/100 to 200/160	EASY - VIP - SMART - SLOPE - WING - PLUS

Utilising Mufle's distinctive step connector system, it is possible to connect drainage channels of differing heights to create greater efficiencies in hydraulic velocity and channel capacity. These efficiencies create benefits in increased drainage performance, outlet number reduction for longer continuous drainage runs, increased self cleansing ability and lower installation costs. Stepped channel are typically recognised by structured increases in neutral channel depths towards a nominated outlet along a specific drainage channel run/length.



N.B. Sizes and weights are subject to usual manufacturing tolerance values.

